

**NEW CONSTRUCTION
ZONED FOR INDUSTRIAL**



LAND FOR SALE

*South Washington Street
Norton MA*

**RE YOU LOOKING TO CREATE A
STRATEGIC ASSET FOR YOUR
PORTFOLIO?**

Looking for land for an investment acquisition? Prime commercially zoned real estate available off Route-495. Close to Boston and Providence RI.

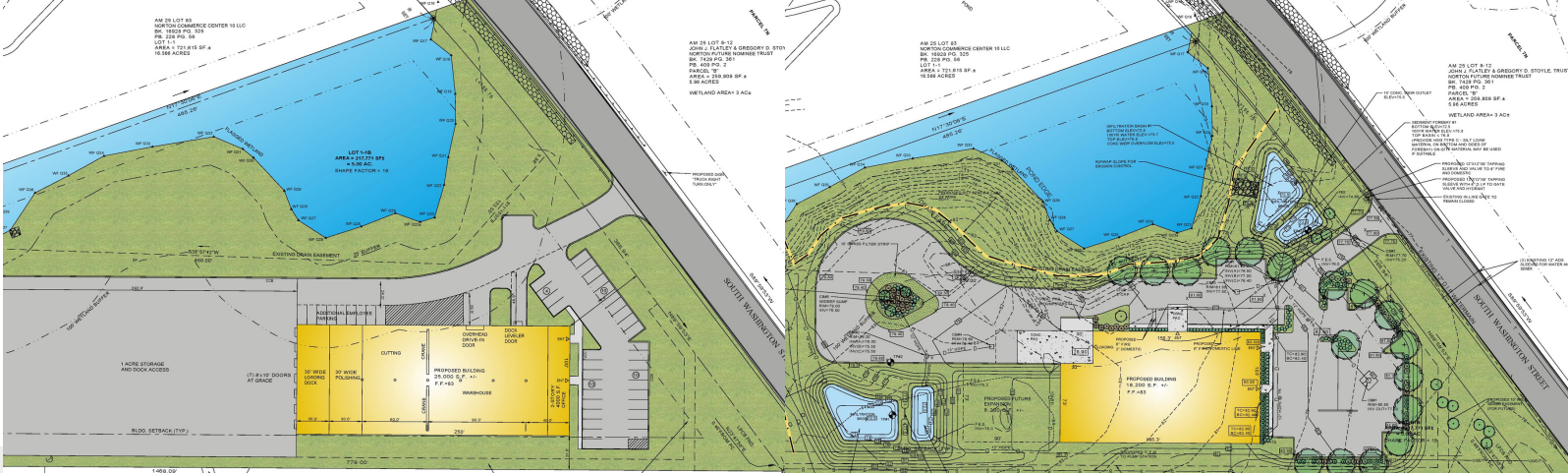

SUGGESTED
\$1,000,000.00

Norton Commerce Center is situated just 1.2 miles to Interstate 495, 6.1 miles to Route 24 and 8.5 miles to Interstate 95. Norton Commerce Center has incredible highway visibility as well as highway signage. The park has a variety of amenities including ample parking, magnificent landscaping, numerous walking areas and a scenic pond. There are also many hotels, restaurants, additional retail and the TPC Boston in proximity.

N Norton Commerce Center

Property Details.

Our commercially zoned property for your Class-A space includes:

- 5.00 acres
- SF 30 - 40,000 SF
- Previously Permitted
- Columbia Gas
- National Grid, Electric
- NC Sewer
- Norton Municipal, Water
- Terrain Flat
- Great access entry to business park
- Visible from Route 495

For more information about this opportunity, please visit www.condyne.com. For any inquiries, please call Tom Nealon at 781.552.4204 or email tnealon@condyne.com.

CONDYNE
CAPITAL PARTNERS, LLC